

SUBMITTAL SHEET

JOB NAME	ITEM TAG
JOB LOCATION	PART NUMBER
CONTRACTOR	DATE
ENGINEER APPROVAL	DATE

NO LEAD WATER SERVICE CURB STOPS

T-5500NL and T-5500MPNL

For underground water service installations only, to permit shutoff of the water supply, from the water main to the building.

90-degree operation with enclosed operating head stops.

Operating head has been drilled to accept stationary rod cotter pin attachment.

Full-port, ball-and-seat design is superior to plug-type designs.

PTFE-coated ball assures positive, bubble-tight shutoff, low torque operation and long service life.

Minneapolis Pattern models (T-5500MPNL) have straight pipe threads on the stem to accept curb boxes.

T-5500NL and T-5500MPNL are available in NPT nominal sizes 3/4" through 2".

Working Pressure, Non-Shock (PSI):

Cold Working Pressure (CWP): 300 psi

Max. Service Temperature: 100°F

MATERIAL SPECIFICATION

PART	MATERIAL
1 End Adapter	Lead-free cast bronze
2 Seats (2)	NBR
3 Ball	PTFE-coated lead-free cast bronze
4 Body	Lead-free cast bronze
5 Stem Locknut	Lead-free cast bronze
6 Stem O-Ring (2)	NBR
7 Stem & Handle	Lead-free cast bronze

DIMENSIONS - INCH

Size	A	B	C
3/4"	2.78	2.56	1-1/2"
1"	3.30	2.72	1-1/2"
1-1/4"	4.45	2.72	2"
1-1/2"	4.68	3.44	2"
2"	4.96	3.72	2"



Pictured:
T-5500NL



Pictured:
T-5500MPNL

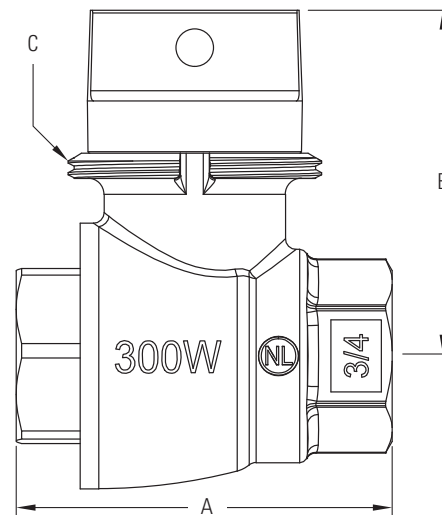

Pictured:
T-5500MPNL Drawing

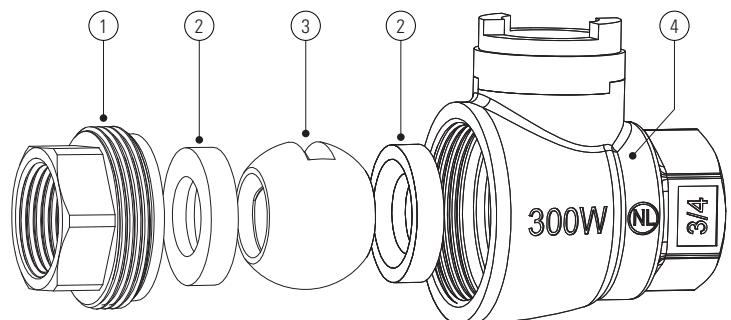
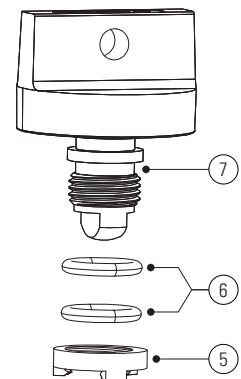

Pictured:
T-5500NL Exploded View

Certifications/Listings:

Third-Party Certified

NSF/ANSI 61: Drinking water system components - Health effects.

NSF/ANSI 372: Drinking water system components - Lead content.

Standards:

AWWA C800: Underground service line valve and fittings.

ANSI/ASME B1.20.1: Pipe threads, general purpose, Inch.