

SUBMITTAL SHEET

JOB NAME	ITEM TAG
JOB LOCATION	PART NUMBER
CONTRACTOR	DATE
ENGINEER APPROVAL	DATE

PEX TUBING-TO-MANIFOLD CONNECTOR

Tube Connector

Durable split ring compression connection applies even compression force across the PEX tubing.

Reliable O-ring seal.

Integral insert stiffener and O-ring channel assure correct connection alignment and a positive seal.

No special tools required: a PEX tubing cutter and adjustable wrench are all that is needed.

Not for use with PEX-AL-PEX tubing.

Working Pressure, Non Shock (PSI): 125 psi
Maximum working temperature: 230°F



Pictured:
3/8" PEX Connector

Pictured:
3/4" PEX Connector

DIMENSIONS						
Size	For connectors that fit BRASS manifold (models M-8000 and M-8200)			For connectors that fit STAINLESS STEEL manifold (models M-8300E & M-8330)		
	W	H	D	W	H	D
5/16"	1.14	1.27	0.79	1.13	1.27	0.88
3/8"	1.14	1.27	0.79	1.13	1.27	0.88
1/2"	1.14	1.27	0.81	1.13	1.27	0.88
5/8"	1.14	1.27	0.86	1.13	1.27	0.88
3/4"	1.43	1.62	1.22	1.37	1.52	1.24

MATERIAL SPECIFICATION		
PART	MATERIAL	SPECIFICATION
1 Insert Adapter	Forged brass (M-8330 Connector: Nickel-chrome plated forged brass)	UNS Alloy C37700
2 O-ring	EPDM rubber	Commercial grade
3 Compression split-ring	Forged brass	UNS Alloy C37700
4 Compression nut	Forged brass (M-8330 Connector: Nickel-chrome plated forged brass)	UNS Alloy C37700

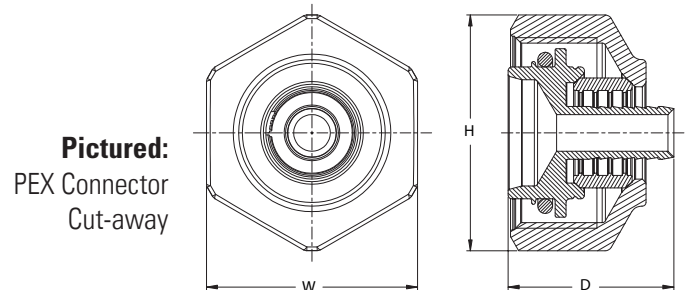

Pictured:
PEX Connector Cut-away

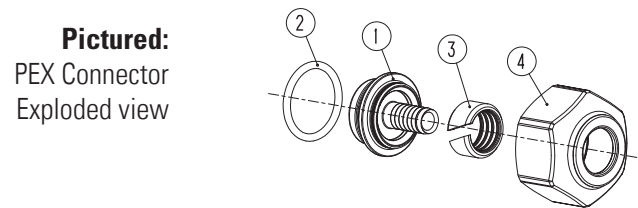

Pictured:
PEX Connector Exploded view

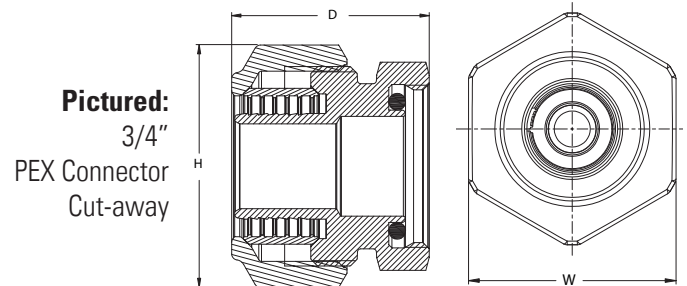

Pictured:
3/4" PEX Connector Cut-away

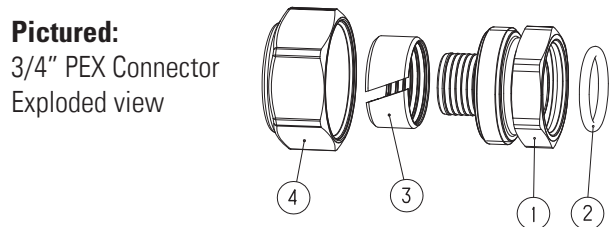

Pictured:
3/4" PEX Connector Exploded view

Standards:

ASTM F876/F877: Standard specification for crosslinked polyethylene (PEX).
ASTM F2623: Standard specification for Polyethylene of Raised Temperature (PE-RT) systems for non-potable water applications.