

SUBMITTAL SHEET

JOB NAME	ITEM TAG
JOB LOCATION	PART NUMBER
CONTRACTOR	DATE
ENGINEER APPROVAL	DATE

LEAD-FREE PRESSURE FITTINGS

PEX x PEX x FNPT Brass Drop-Ear Tee

Drop-ear holes accept most screw fastener types, permitting easy attachment to cross-brackets.

Integral drop-ears and large flat-back, provide enhanced stability between the PEX and the threaded branch leg.

Stand off height provides ample room for the crimp tool to be used after the fitting has been mounted.

Available in 1/2" PEX x 1/2" FNPT and 3/4" PEX x 3/4" FNPT sizes.

Working Pressure, Non Shock (PSI)

Cold working pressure (CWP): 125 PSI

Saturated Steam (WSP): Not suitable for steam service

MATERIAL SPECIFICATION	
PART	MATERIAL
1 Fitting Body	Lead-free forged brass

DIMENSIONS - Inch				
Size	A	B	C	D
1/2"	1.32	2.05	1.18	1.06
3/4"	1.72	2.36	1.77	1.30

Certifications/Listings:

Third-party certified.

NSF/ANSI 372: Drinking water system components - Lead content.

Standards:

ASTM F1807: Metal insert fittings utilizing a copper crimp ring or stainless steel clamps.

ANSI/ASME B1.20.1: Pipe threads, general purpose, Inch.



Pictured:
PEX x FNPT Drop-ear tee

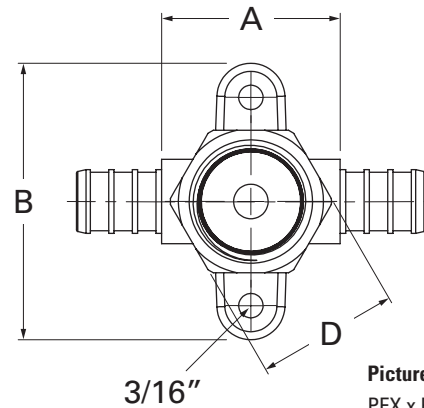

Pictured:
PEX x FNPT Drop-ear tee
Overhead view

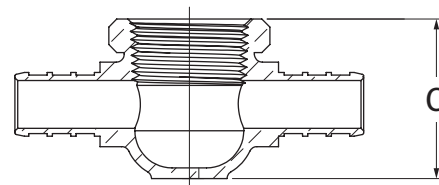

Pictured:
PEX x FNPT Drop-ear tee
Cut-away