

INSTALLATION GUIDE

EMERGENCY REPAIR COUPLER

INSTALLATION REPAIR INSTRUCTIONS

1. Cut out the damaged section of tube.
2. Install the proper Stainless Steel Compression nut, split ring and insert adapter over the end of each piece to tubing to be repaired.
 - a. **Note:** You will also need (1) 830-819 repair coupler.
3. Using two adjustable wrenches, tighten one compression nut onto the repair coupler. Repeat for the second side.
4. Pressure test the repair for leaks. Once it has been determined that there are NO leaks at the repair, the fitting must be wrapped before it is placed in concrete.
5. Pull back 6 to 8 inches of the protective film from the end of the emergency repair tape.
6. Starting about 2" away for the repair coupler, stretch and fully overlap the repair tape onto itself. By 1/2" stretch at least twice its length for best fusion.
7. Continue wrapping until you completely cover the coupling and onto the tube by about two inches.
8. Cut the wrap from the roll and stretch the end around the tube onto itself.
9. The silicone begins to fuse immediately and can be covered with concrete as soon as you are done wrapping it.
 - a. **Note:** A mechanical joint, such as the emergency repair coupler, should only be used in an emergency situation. If time allows, a damaged tube should be completely replaced instead of installing an inaccessible mechanical joint.

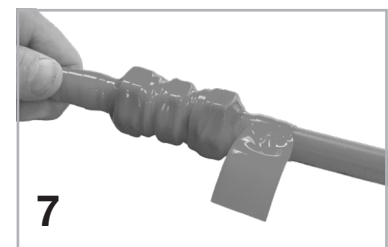
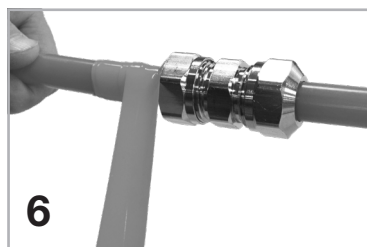
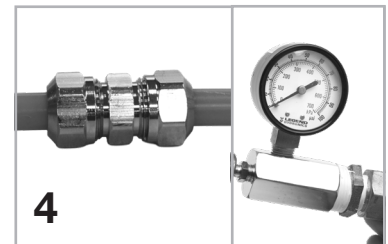
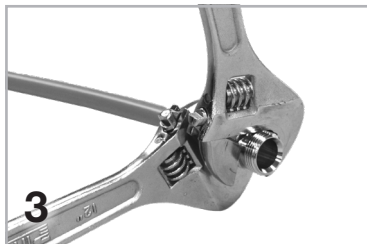

NOTICE

Failure to follow these installation instructions may void the product warranty and could result in serious property damage and/or bodily injury, including death.

WARNING

When preparing for installation, utilize all proper personal protection equipment (PPE), including durable gloves, eye protection, hard hats, and steel-toed boots..