

SUBMITTAL SHEET

JOB NAME	ITEM TAG
JOB LOCATION	PART NUMBER
CONTRACTOR	DATE
ENGINEER APPROVAL	DATE

NO LEAD MONOFLOW TEE

Model T-570NL & T-570PNL

Made of lead-free cast brass.

For PEX F1807, PEX F1960, and Sweat configurations.

Monoflow Tees divert flow of water from main line to branch line and back again to main line.

Allows for a radiant system that does not require separate supply and return piping for each unit.

Install in proper location and orientation to ensure efficient operation of the heating system.

Not suitable for steam.

Max pressure and temperature may exceed that of PEX tubing.

Available in nominal sizes 3/4 x 1/2" – 1-1/4 x 3/4".

Working Pressure, Non Shock (PSI)

Cold working pressure (CWP): 150 PSI

Max Temp: 200°F

MATERIAL SPECIFICATION	
PART	MATERIAL
Body	Lead-free Cast Brass

DIMENSIONS		
Size	A	B
3/4"x1/2"	2.28	1.16
1"x1/2"	2.52	1.16
1"x3/4"	2.52	1.24
1-1/4"x1/2"	2.52	1.32
1-1/4"x3/4"	2.72	1.36
3/4" PEX x 1/2" PEX	3.40	1.70
3/4" PEX x 1/2" CU	3.40	1.10
3/4" F1960 x 1/2" F1960	4.10	1.80
3/4" F1960 x 1/2" CU	4.10	1.10



Pictured:
Model T-570NL



Pictured:
Model T-570PNL

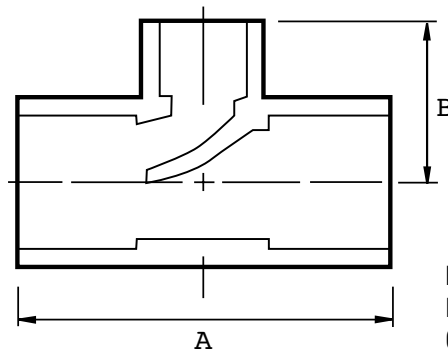

Pictured:
Model T-570NL
Cut-away