

SUBMITTAL SHEET

JOB NAME		ITEM TAG
JOB LOCATION		PART NUMBER
CONTRACTOR	DATE	
ENGINEER APPROVAL	DATE	

NO LEAD BRASS COMPRESSION-INLET BOILER DRAIN

T-523NL

Compression inlet connection permits simple attachment to copper tubing without the need for soldering and its associated hazards.

Equipped with a stem packing and packing nut, which are more durable than pack-less types. Ideal for frequent-use applications.

Over-bonnet design utilizes more material in a high-stress area, offering a better seal to the body and enhanced stem support.

Available in Nominal 1/2" CTS (5/8" O.D.) compression inlet x 3/4" MGHT hose thread outlet sizes.

Working Pressure, Non Shock (PSI)

Cold working pressure (CWP):	125 psi
Saturated steam (WSP):	Not suitable for steam service.
Maximum service temperature:	180°F



Pictured:
T-523NL

MATERIAL SPECIFICATION			
PART	MATERIAL	SPECIFICATION	
1	Handle nut	Wrought brass	UNS Alloy C36000
2	Identification disc	Aluminum	AA Type 1070
3	Handle	Cast aluminum	UNS Alloy A03830
4	Packing nut	Forged brass	ASTM B124 UNS Alloy C37700
5	Stem packing	NBR rubber	Commercial grade
6	Bonnet	Cast brass	ASTM B584 UNS Alloy C85700
7	Bonnet seal	NBR rubber	Commercial grade
8	Seal support washer	Stainless steel	AISI Grade 304
9	Stem	Lead-free cast brass	UNS Alloy C46500
10	Seat washer	NBR rubber	Commercial grade
11	Seat retaining screw	Lead-free brass	JIS H3260 Grade C2600W
12	Body	Lead-free cast brass	UNS Alloy C46500
13	Compression ferrule	Lead-free brass	UNS Alloy C27000
14	Compression nut	Forged brass	ASTM B124 UNS Alloy C37700

DIMENSIONS - Inch			
Nominal Size:	A - Overall Height (Open)	B - Overall Width	C - Handle Diameter
1/2" Nominal CTS (5/8" O.D.) x 3/4" MGHT	4.08	1.97	2.09

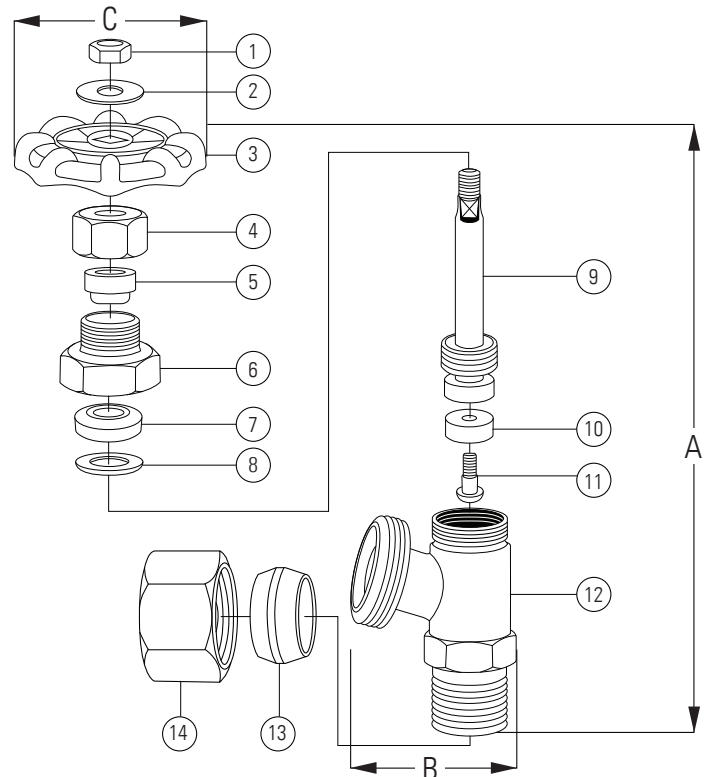

Pictured:
T-523NL
Exploded View

Certifications/Listings:

Third-party certified.
NSF/ANSI 61: Drinking water system components - Health effects.
NSF/ANSI 372: Drinking water system components - Lead content

Standards:

ANSI/ASME B1.20.7: Hose coupling screw threads, Inch