

SUBMITTAL SHEET

JOB NAME	ITEM TAG
JOB LOCATION	PART NUMBER
CONTRACTOR	DATE
ENGINEER APPROVAL	DATE

NO LEAD BRONZE IN-LINE CHECK VALVE

T-450NL

A durable, heavy-wall cast bronze design is ideal for water well applications.

The 450 is designed for installation onto water well drop pipe; the body's outside diameter is machined smooth to minimize the chance of snagging other components within the well casing.

The spring-loaded stem-disc and elastomer o-ring seal are a silent closure design type.

The half-pound cracking pressure is ideal for all well pumps types.

Its fully-guided stem minimizes over-travel, which reduces the chance of piston failure.

This valve can be installed in vertical or horizontal positions.

Available in nominal sizes 1/2" through 4" FNPT.

Working Pressure, Non Shock (PSI)

Cold working pressure (CWP):	200 psi
Saturated steam (WSP):	Not suitable for steam service
Maximum service temperature:	250 °F



Pictured:
T-450NL

MATERIAL SPECIFICATION

PART	MATERIAL	SPECIFICATION
1 Body	Cast bronze	UNS Alloy C87850
2 Piston assembly	Cast bronze	UNS Alloy C87850
3 Spring	Stainless steel	AISI 304
4 O-ring	Buna-N (NBR) rubber	Commercial grade

DIMENSIONS - Inch

Size	A	B
1/2"	2.40	1.26
3/4"	2.74	1.50
1"	3.23	1.77
1-1/4"	3.62	2.13
1-1/2"	4.04	2.36
2"	5.04	3.03
3"	7.28	4.21
4"	10.24	5.55

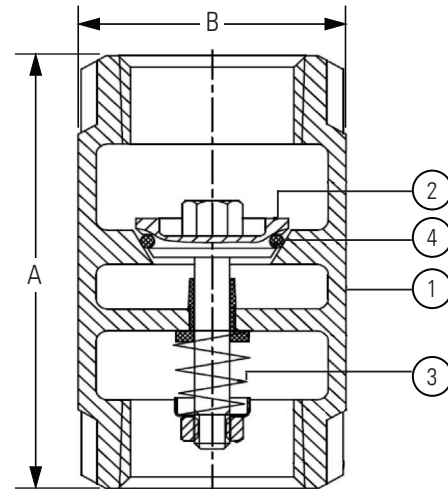

Pictured:
T-450NL
Cut-away view

Certifications/Listings:

Third party certified.
NSF/ANSI 61: Drinking water system components - Health effects.
NSF/ANSI 372: Drinking water system components - Lead content.

Standards:

ANSI/ASME B1.20.1: Pipe threads, general purpose, Inch

T-450NL Pressure Drop Chart

