

SUBMITTAL SHEET

JOB NAME	ITEM TAG
JOB LOCATION	PART NUMBER
CONTRACTOR	DATE
ENGINEER APPROVAL	DATE

NO LEAD IPS/PEP PACK JOINT X MNPT ADAPTER

T-4320NL

Designed and manufactured for the repair or construction of new underground water service applications only.

IPS and PEP pack-joint end connections provide the maximum pullout resistance against internal pressure variations and backfilling stress.

Insert stiffeners are required at each pack-joint connection, when installing on Polyethylene (PE) plastic pipe.

Available in nominal sizes 3/4" & 1" IPS x MNPT, and 1" thru 2" PEP x MNPT configurations.

Specifications:

Manufactured in compliance with the latest version of AWWA C800, for high pressure.

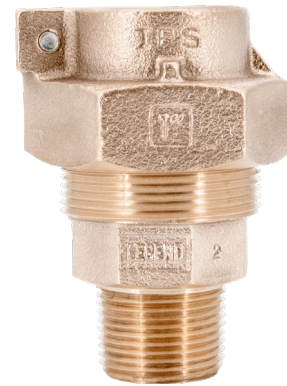

**Pictured:
T-4320NL**

MATERIAL SPECIFICATION		
PART	MATERIAL	
1 Body	Lead-free cast bronze	
2 Pack-joint nut	Cast bronze	
3 Pack-joint gasket	Buna-N (NBR) nitrilic rubber	
4 Pack-joint anti-friction ring	PTFE	
5 Pack-joint clamp bolt	Stainless steel	

DIMENSIONS			
Size	A	B	
3/4" IPS	3.12	1.85	
3/4" IPS x 1" MNPT	3.25	1.85	
1" IPS	3.70	2.40	
1" PEP	3.70	2.40	
1-1/4" PEP	3.75	2.63	
1-1/2" PEP	4.50	3.00	
2" PEP	4.70	3.42	

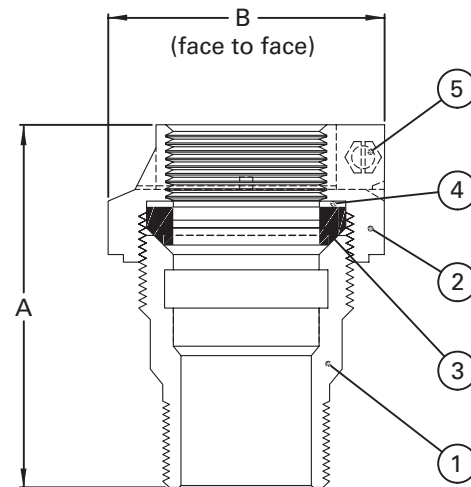

**Pictured:
T-4320NL
Cut-away**

Certifications/Listings:

Third-party certified.
NSF/ANSI 61: Drinking water system components - Health effects.
NSF/ANSI 372: Drinking water system components - Lead content.

Standards:

AWWA C800: Underground service line valve and fittings.
ANSI/ASME B1.20.1: Pipe threads, general purpose, Inch.