

SUBMITTAL SHEET

JOB NAME	ITEM TAG
JOB LOCATION	PART NUMBER
CONTRACTOR	DATE
ENGINEER APPROVAL	DATE

ABS COMPACT-PATTERN BALL VALVE FOR ABS SCHEDULE 40 PIPE

S-608

Constructed of heavy-duty, corrosion-proof, virgin ABS resin.
 PTFE seats and EPDM stem O-ring assure maintenance-free operation and maximum service life.
 Compact-pattern molded-in-place body and one-piece ball-stem design, provide exceptional resistance to wear and to pipeline stress distortion.
 Designed and certified for installation onto Schedule 40 ABS pipe, sump-pump component isolation or drain-waste-vent applications.
 Not suitable for use with petroleum-based medias or compressed-air service.
 Solvent-weld end connection types available in Nominal Pipe Size 1-1/2".

Working Pressure, Non Shock (PSI)

Cold Working Pressure (CWP): 150 psi @ 73°F
 Working Steam Pressure (WSP): Not suitable for steam service
 Maximum service temperature: 180°F



Pictured:
S-608

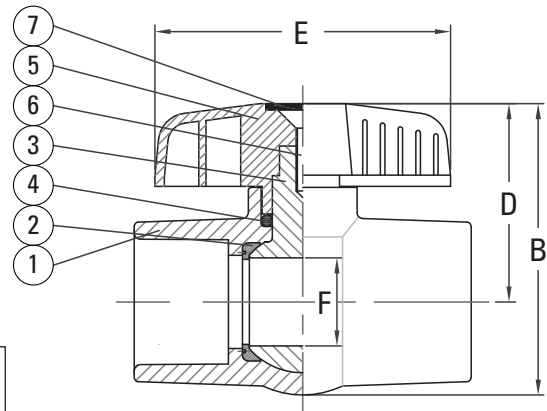

Pictured:
S-608, 1-1/2"
Cut-away view

MATERIAL SPECIFICATION			
PART	MATERIAL	SPECIFICATION	
1 One-piece body	ABS resin	ASTM D4673	
2 Seats (2)	PTFE elastomer	Commercial grade	
3 One-piece ball-stem	CPVC resin	ASTM D1784, Class 23447	
4 Stem O-ring	EPDM elastomer	Commercial grade	
5 Handle	ABS resin	Impact grade	
6 Handle Retaining Screw	Zinc-plated steel	ASME B18.6.7M	
7 Screw cover	ABS resin	Impact grade	

DIMENSIONS - Inch						
Nominal IPS	A	B	C	D	E	F
1-1/2"	5.12	4.47	2.95	2.99	4.29	1.42

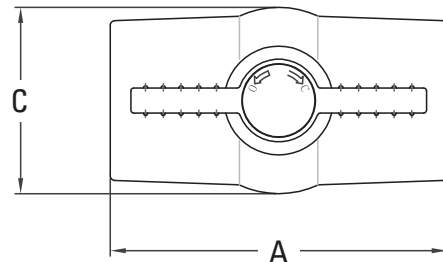

Pictured:
S-608, 1-1/2"
Top view

Standards:

ASTM D2661: Standard Specification for Acrylonitrile-Butadiene-Styrene (ABS) Schedule 40 Plastic Drain, Waste and Vent Pipe and Fittings.
 ASTM D3965: Standard Classification System and Basis for Specifications for Rigid Acrylonitrile-Butadiene-Styrene (ABS) Materials for Pipe and Fittings.
 ASTM D4673: Standard Classification System for and Basis for Specification for Acrylonitrile-Butadiene-Styrene (ABS) Plastics and Alloys Molding and Extrusion Materials.