

SUBMITTAL SHEET

JOB NAME	ITEM TAG
JOB LOCATION	PART NUMBER
CONTRACTOR	DATE
ENGINEER APPROVAL	DATE

NO LEAD PRESS BALL VALVE WITH CAP & CHAIN

P-1002CCNL

Dezincification-resistant (DZR) forged brass resists corrosion from exposure to a wide variety of water conditions.

Cap is gasketed and tethered.

Press-to-connect end connections are designed for installation onto ASTM B88 types K, L and M hard-drawn copper tubing.

End connections are compatible with commercially-available VUS profile jaws.

Available in nominal sizes 1/2" to 1".

Working Pressure, Non-Shock (PSI)

Cold Working Pressure (CWP) 600 psi

Saturated Steam: Not recommended for steam applications



**Pictured:
P-1002CCNL**

MATERIAL SPECIFICATION		
PART		MATERIAL
1	Handle Nut	Steel
2	Handle	Steel
3	Packing Nut	Forged Brass
4	Stem Packing	PTFE
5	Press O-Ring	EPDM
6	Body	Lead-Free Forged Brass
7	Stem O-Ring	EPDM
8	Stem	Lead-Free Forged Brass
9	Seats (2)	PTFE
10	Ball	Lead-Free Forged Brass
11	End Adapter	Lead-Free Forged Brass
12	Cap Gasket	EPDM
13	Cap	Forged Brass
14	Chain	Steel

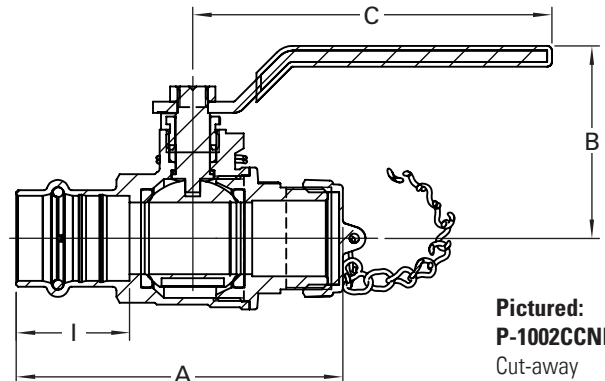

**Pictured:
P-1002CCNL
Cut-away**

DIMENSIONS				
Size	A	B	C	I (Insert)
1/2"	3.05	1.80	3.46	1-1/8"
3/4"	3.40	2.08	4.30	1-3/16"
1"	3.66	2.25	4.30	1-3/16"

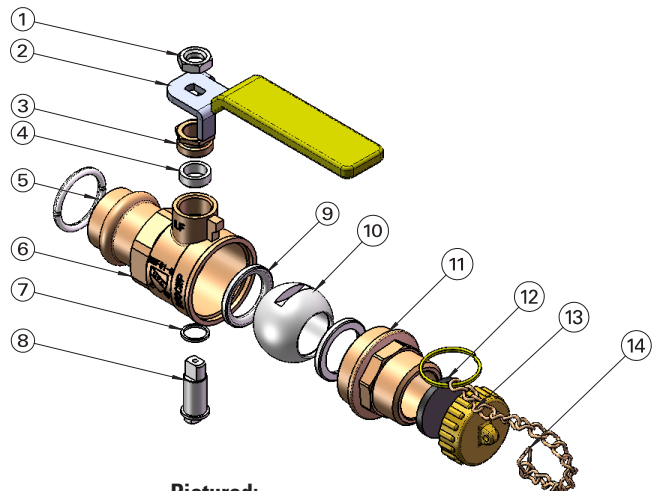

**Pictured:
P-1002CCNL
Exploded View**

Certifications/Listings:

Third-Party certified.

NSF/ANSI 61: Drinking water system components - Health effects.

NSF/ANSI 372: Drinking water system components - Lead content.

Standards:

ANSI/ASME B16.51: Copper and copper alloy press-connect pressure fittings.

ANSI/ASME B1.20.7: Garden hose threaded connection.