

SUBMITTAL SHEET

| | | |
|-------------------|------|-------------|
| JOB NAME | | ITEM TAG |
| JOB LOCATION | | PART NUMBER |
| CONTRACTOR | DATE | |
| ENGINEER APPROVAL | DATE | |



LEAD-FREE CAST PRESSURE FITTINGS

CAST BRASS DROP-EAR ELBOWS

Drop-ear holes accept most screw fastener types, permitting easy attachment to cross-brackets.

Integral drop-ears and flat-back elbow shape, place more of the elbow's surface against the bracket, enhancing stability when installing the shower arm.

FNPT threads to accommodate plated shower arms

Working Pressure, Non Shock (PSI)

125 CWP

Not suitable for steam service

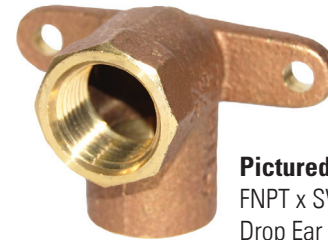

Pictured:
FNPT x SWEAT
Drop Ear Elbow

| MATERIAL SPECIFICATION | | |
|------------------------|-----------------|------------------|
| PART | MATERIAL | SPECIFICATION |
| 1 Fitting body | Lead-free brass | UNS Alloy C46400 |

| Dimensions - Inch | *(corner-to-corner / flat-to-flat) | | | | | |
|-------------------------|------------------------------------|------|-------------|------|------|------|
| | Size | A | B | C* | D | E |
| 3/8" FNPT x 1/2" Sweat | 1.29 | 1.12 | 0.89 / 0.83 | 2.09 | 1.63 | 0.13 |
| 1/2" FNPT x 1/2" Sweat | 1.41 | 1.14 | 1.05 / 0.98 | 2.09 | 1.63 | 0.13 |
| 1/2" Sweat x 1/2" Sweat | 0.93 | 1.34 | 0.77 | 2.09 | 1.63 | 0.13 |

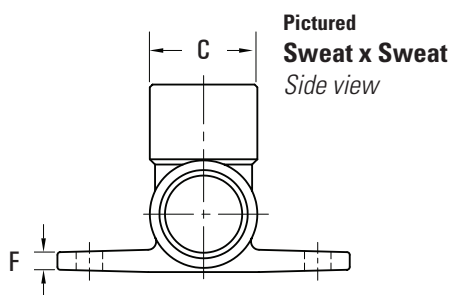
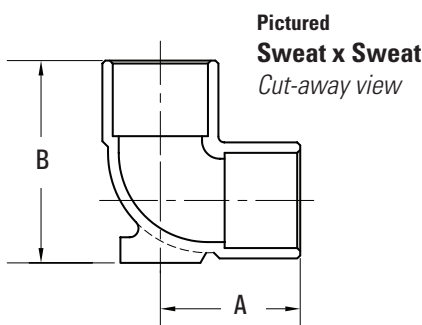
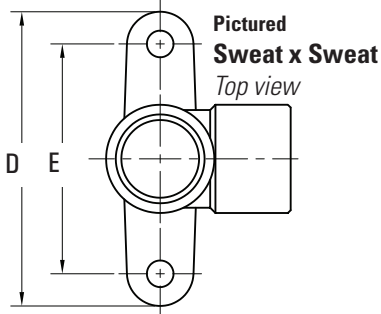
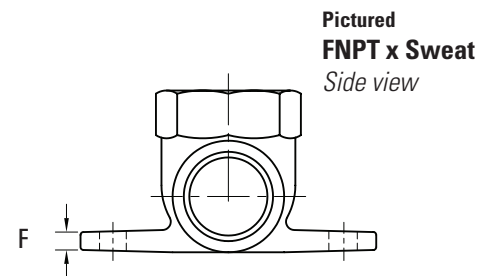
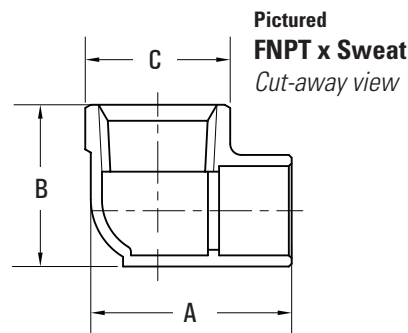
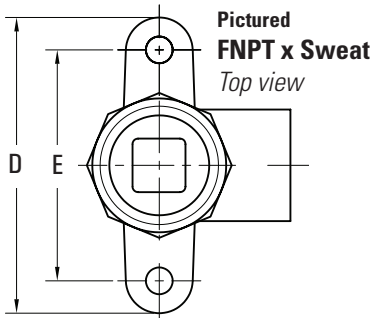

Certifications/Listings:

Third-party certified.

NSF/ANSI 61: Drinking water system components - Health effects.

NSF/ANSI 372: Drinking water system components - Lead content.

Standards:

ANSI/ASME B1.20.1: Pipe threads, general purpose, Inch.

ANSI/ASME B16.18: Cast Pressure alloy solder-joint pressure fittings.